



GREATER NOIDA WEST

By



**Premium Commercial  
At Sec.16-B, Greater  
Noida West**





# Location Advantages

- Surrounded By more than 2 Lakh Housing Apartments.
- Metro Connectivity.
- Seamless connectivity from Delhi, Ghaziabad, Noida, Siddarth Vihar, Crossing Republic & Indrapuram.
- Well Planned Region in the Delhi-NCR with 25% of Green Area.
- Prominent Hospitals, Reputed Schools & Colleges in close vicinity.
- Mix of manufacturing Industries, as well as IT/ITES provided excellent job opportunities.





# Walkable Neighborhood

- ATS Homecraft (2 Mins)
- Gulshan Bellina (1 Mins)
- Gaur Saundaryam (2 Mins)
- RG Luxury (1 Mins)
- Cherry County (1 Mins)
- Panchsheel 1 & 2 (2 Mins)
- Supertech Ecovillage (2 Mins)
- Nirala Ashpire (1 Min)
- Ajanara Homes & Le-garden (1 Min)
- SKA , Saviour, Fushion , French and many more.....





# A Development Surrounded By Residential Hub

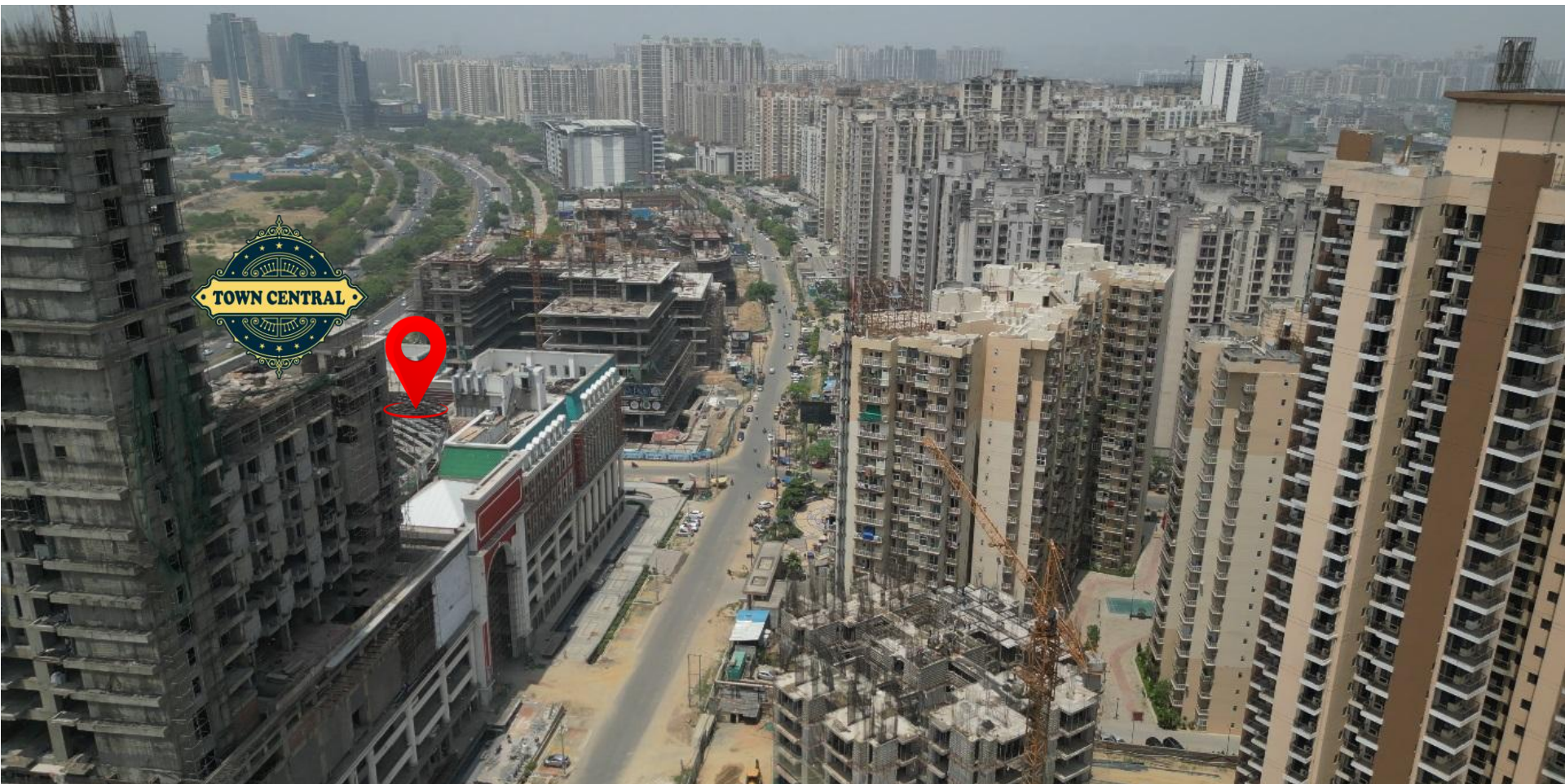

# Unparalleled Transport Connections

The strategic location of Town Central makes daily commute convenient with well-connected roadways like the Noida Expressway and DND Flyover. Noida is also well-laid with metro connectivity all across the town

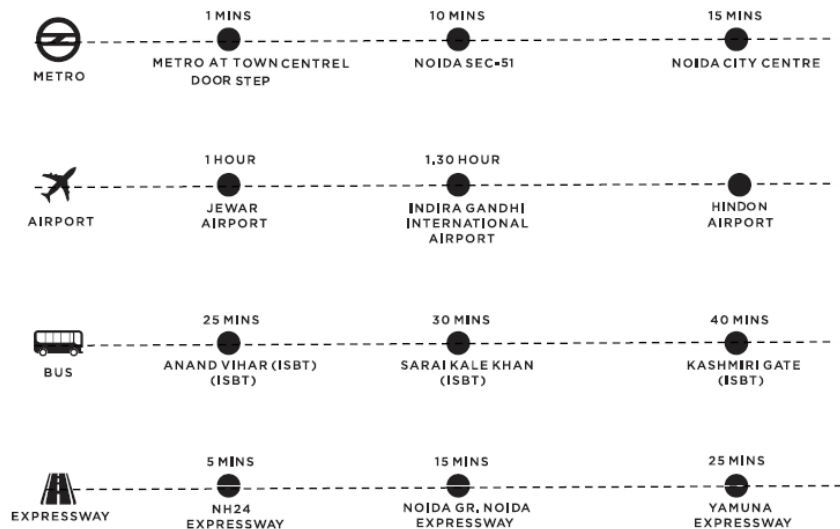

## AT THE HEART OF GREATER NOIDA WEST







Situated on 130 Mtr Wide Road Connected to Jewar Airport

# Development Brief...



**Plot Size**  
4.5 acres  
(18001.75 sq.mt)



**Overall Development size**  
13 lakh sqft  
(1,20,773 sq.mt)



**Ground Coverage**  
77,000 sqft  
(7177 sq.mt)



**Entertainment Zone**

34,375 sft  
(3,194 sq.mt)



**Destination Banquet**

57,041 sft  
(5,300 sq.mt)



Member ITC's hotel group

**Hotel ITC Fortune**

1.18 lakh sqft  
(10,981 sq.mt)



1.20 lakh sqft  
(11,148 sq.mt)



**Office**  
48,000 sqft  
(4,460 sq.mt)



**Multiplex**  
62,439 sqft  
(5,801 sq.mt)

**Food Court,  
Fine Dining &  
Sky Bar/Lounge**

1.55 lakh sqft  
(14,400 sq.mt)



**Retail**

4.25 lakh sqft  
(39,483 sq.mt)

**Green Belt**

20m wide  
Sustainable  
Ecosystem



# Dreams Turn



# Into Reality





Interior View





Development Façade View





Food Court View



# A Transformation...

## Retail Facade





# Unique Features

## Enhancing Retail

**A Vibrant Family  
Entertainment Center–**  
A premium vibrant  
Gaming Zone



**Experiential Retail** – hybrid of indoor & outdoor shopping experience



**Grand Atrium** – Enjoy Grand Openness with 40,000 Sq. Ft. Central Atrium Area.





# Unique Features Enhancing Retail



**Grand Entrance –**  
20 Mtr wide Entry Gate From 130 Mtr. And 24 Mtr Road Society Facing

**A Sky Lounge –** Premium lounge experience on the 8<sup>th</sup> floor



Sky-bar & Lounge



**Parking –** Convenience of over 1500 4-wheeler and 2-Wheeler parking facility for retail users

**Events at Grand Atrium –** the Grand Atrium is a crowd magnet during events







Grand Entrance From 130Mtr. Wide Road

# A Comprehensive Retail Offering





# Space Planning | Retail





# Retail Layout

## Masterplan & Retail Design





# Lower Ground Floor



Hyper market



Fashion Anchor



Electronics



Banquet



Passenger Lift



Escalator Up



Escalator Down



Service Lifts



[illegible]

- Passenger Lift
- Escalator Up
- Escalator Down



**Sai Creations**  
*The Destination for Watches*





# First Floor

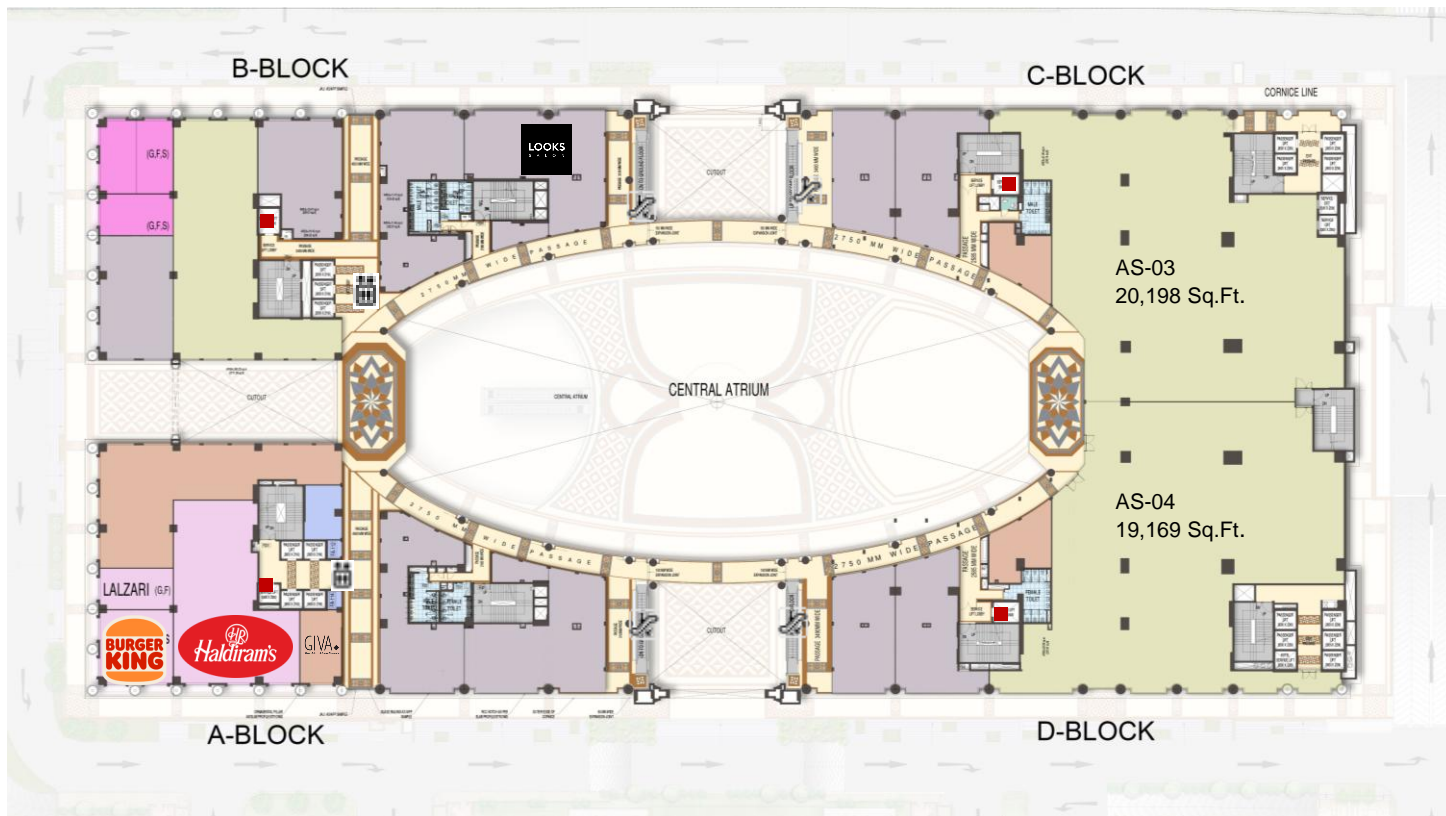

Passenger Lift



Escalator Up



Escalator Down



Service Lifts



# Second Floor

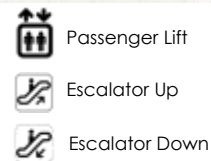
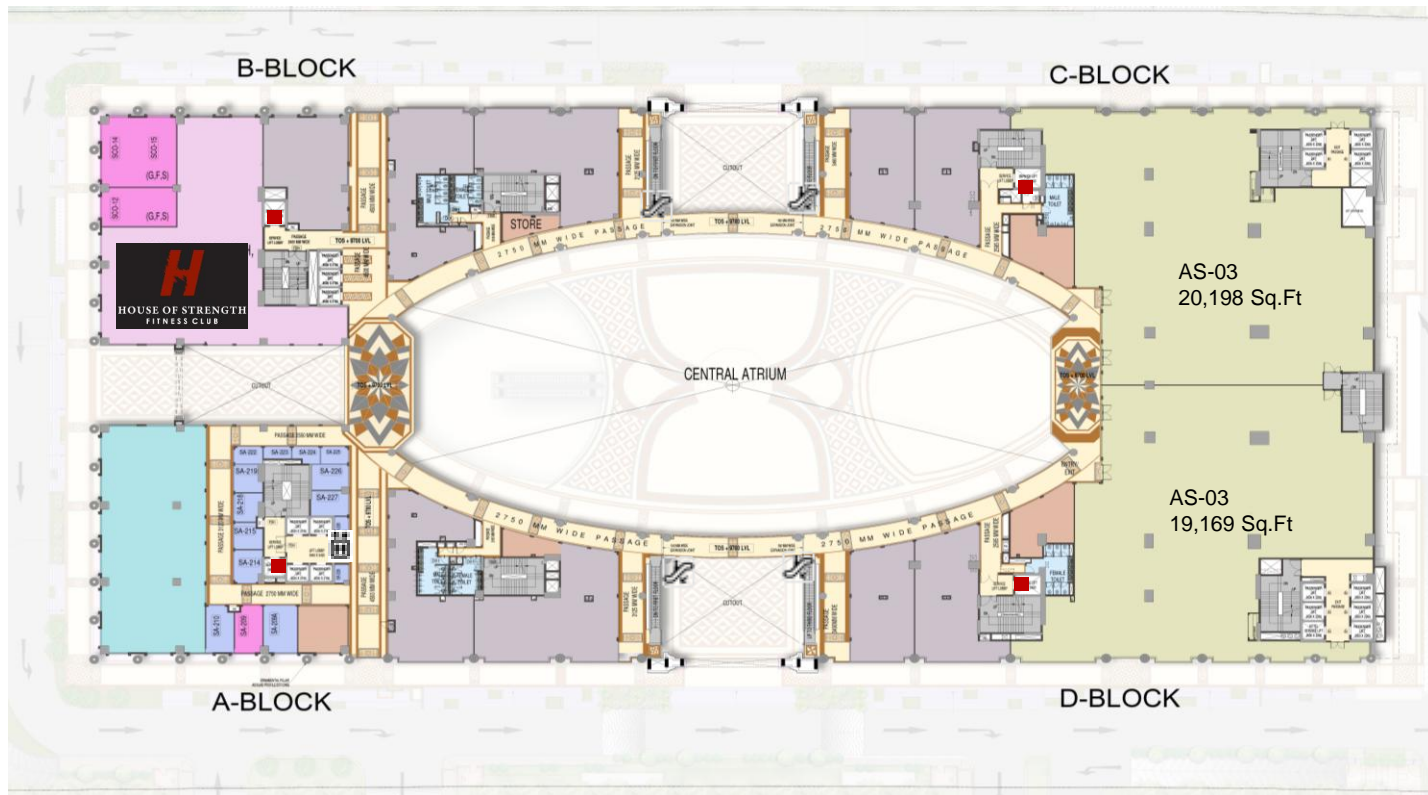

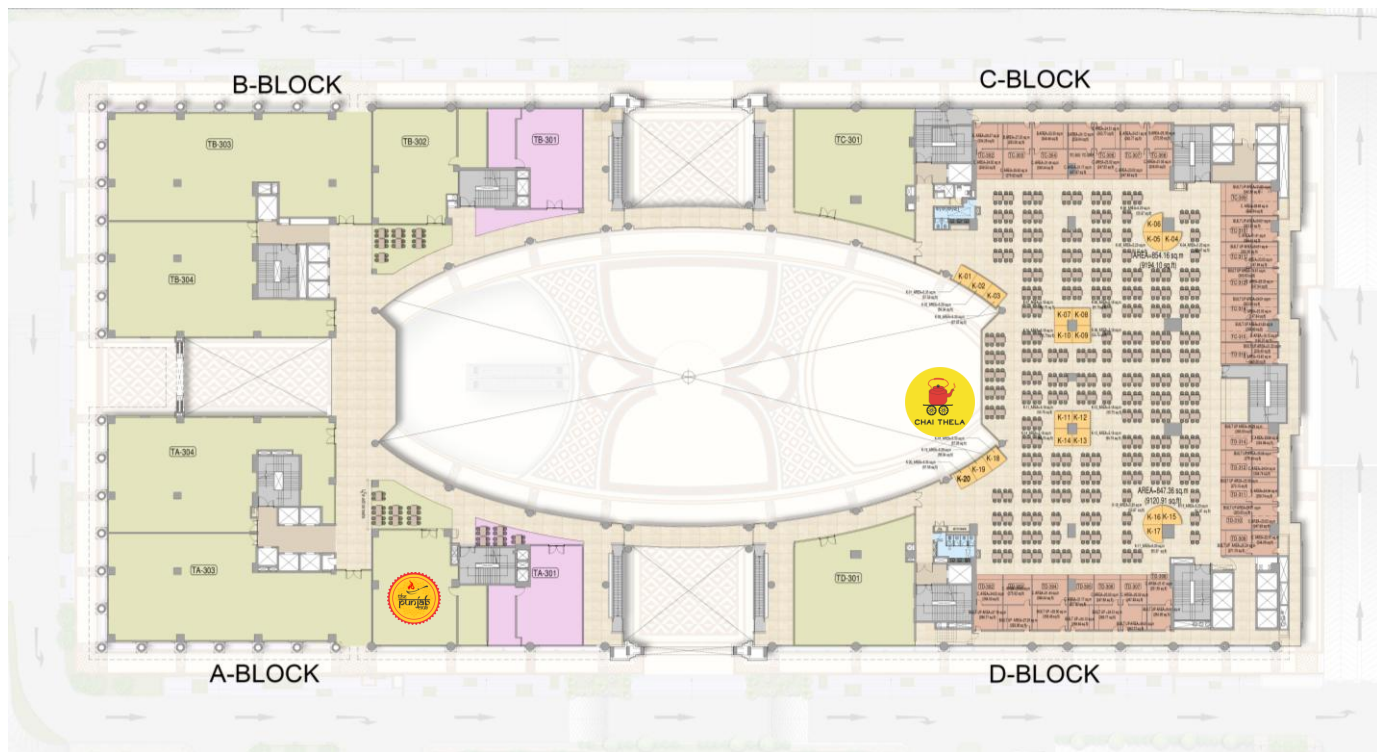

## Restaurant & Food Court



Food &  
Beverage



Passenger Lift



Escalator Up



Escalator Down





Service Lifts

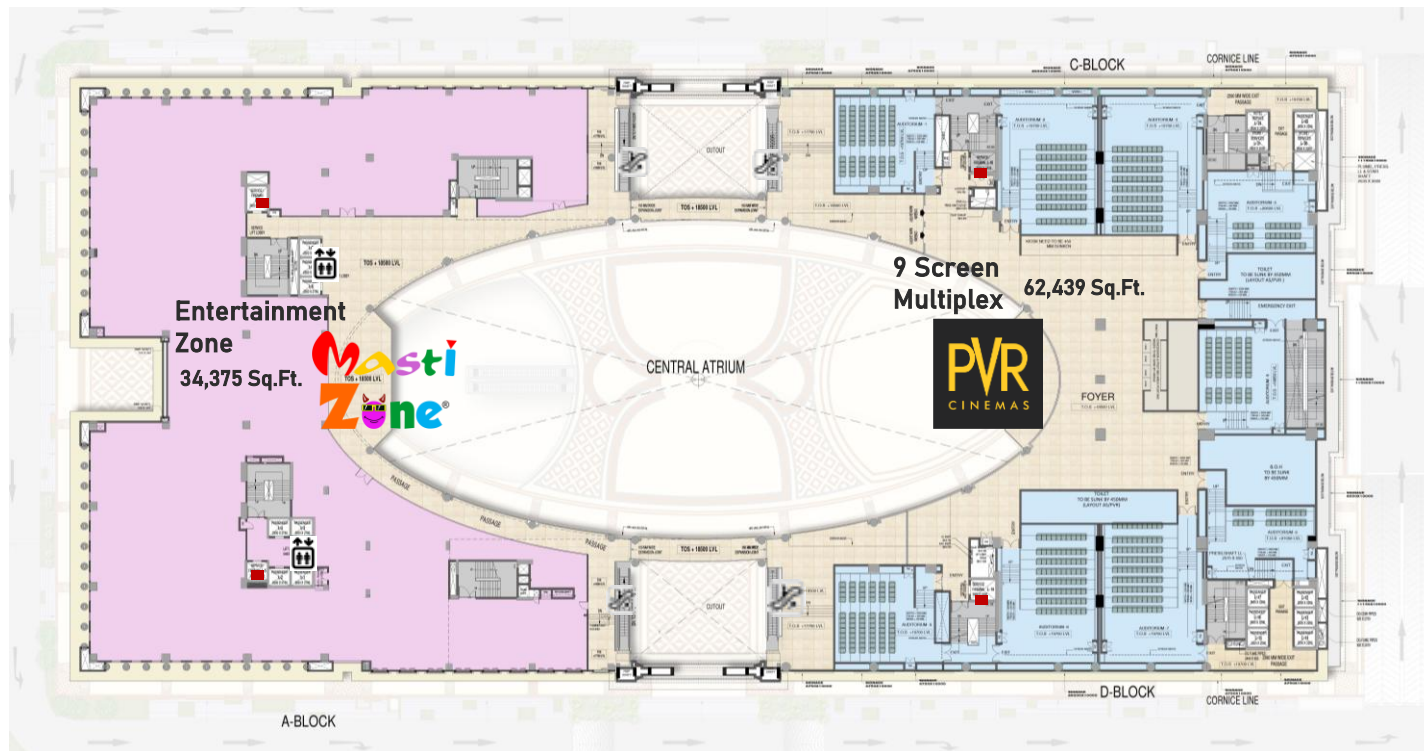

# Fourth & Fifth Floor



## Entertainment Zone & 9 screen Multiplex

-  Passenger Lift
-  Escalator Up
-  Escalator Down

 Service Lifts

# Destination Banquet





# Terrace Floor

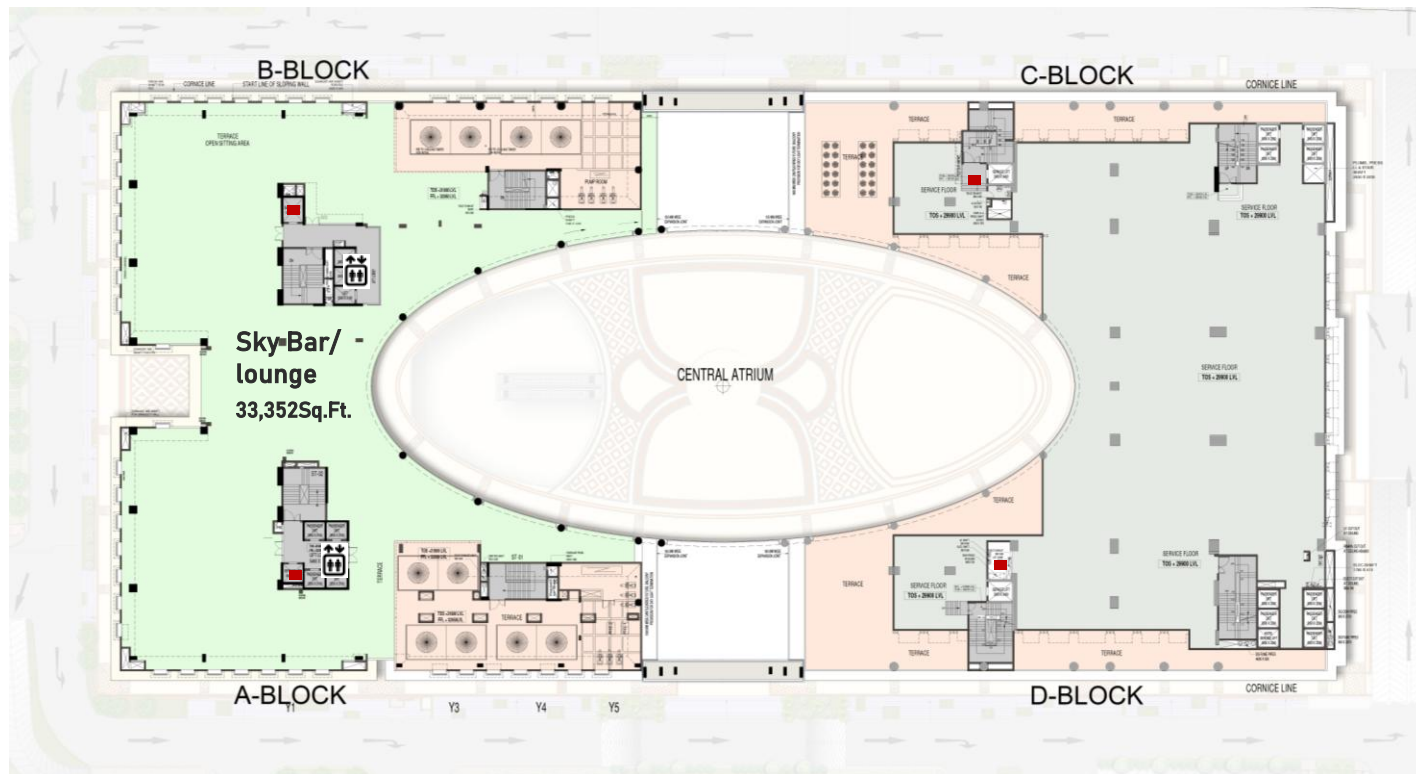

## Sky Bar & Lounge



Food &  
Beverage



Passenger Lift



Service Lifts

# Eighth Floor

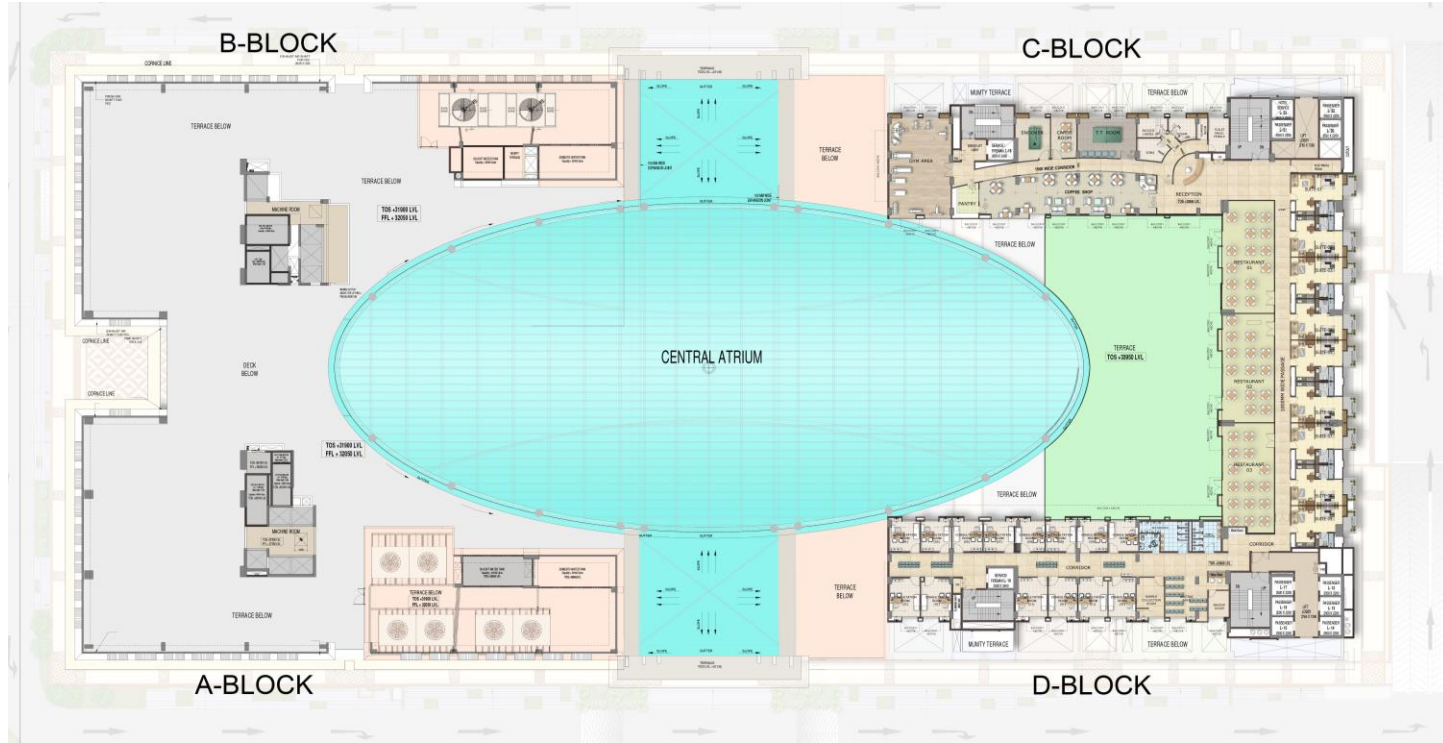

Open Terrace Restaurants/ Gym/Club



# Partners in Success

**Architect  
Hafeez  
Contractor**

**Principal  
Architect**

**VINTECH**  
CONSULTANTS  
CONSULTING ENGINEERS  
& PROJECT MANAGERS

**Structure  
Consultant**

**Consulting**  
Engineering | Building | Refection

**MEP  
Consultant**

**ojom**  
ARCHITECTS  
& PLANNERS  
Over 15 Years of Experience

**Associate  
Architect**

**Midas Touch**  
Interior Designer

**designmatrix**  
TRUE TO LIGHT

**Façade Life  
Consultant**

**TPA**

**Traffic & Parking  
Consultant**

**hazel  
earth**  
landscape  
architecture

**Landscape  
Architect**

**MATRIX**  
VERTICAL TRANSPORTATION

**Lift  
Consultant**



**GREATER NOIDA WEST**



# Delivered Projects



**KRISHNA APRA PLAZA  
SECTOR 18, NOIDA**



**KRISHNA APRA SHOPPING  
INDRAPURAM**



**KRISHNA APRA SAPPHIRE PLAZA,  
INDRAPURAM**



**KRISHNA APRA ROYAL VIEW  
GR. NOIDA**



**KRISHNA APRA D MALL  
INDRAPURAM**



**KRISHNA APRA ALPHA PLAZA,  
GR. NOIDA**



**KRISHNA APRA GOLF VIEW  
PLAZA, Gr. NOIDA**



**KRISHNA APRA PARK  
PLAZA INDRAPURAM**



# Delivered Projects



**KRISHNA APRA DAWARKA  
INDRAPURAM**



**KRISHNA APRA DAWARKA PLAZA-II,  
GR. NOIDA**



**KRISHNA APRA NORTH EX PLAZA  
GR. NOIDA**



**KRISHNA APRA BUSINESS SQUARE  
INDRAPURAM**



**KRISHNA APRA SAPPHIRE  
INDRAPURAM**



**ROYAL COURT  
GR. NOIDA WEST**



**KRISHNA APRA RESIDENCY  
INDRAPURAM**



**KRISHNA APRA GARDEN  
INDRAPURAM**





# Thank you!

RERA Reg. No: - UPRERAPRJ7066,  
UPRERAPRJ7355,  
UPRERAPRJ7334

**PKS BUILDMART PRIVATE LIMITED**

**Corporate Office:** B-127, Sector 63, Noida. (U.P.) 201301

**Site office at:** Plot- C-4, Sector- 16B, Greater Noida West. .(U.P.)